

# Echoflex Solutions Release Note

## Elaho DMX Scene Controller

---

**Product Line:** Elaho DMX Scene Controller  
**Description:** Version 3.3.4 firmware

### DMX Scene Controller Components

Firmware	3.3.4.950
Echo Protocol	3.3.4.950

**Effective Date:** 2021-04-29

## Purpose

This release incorporates improvements from newer Echo Protocol versions.

For any questions relating to the contents of this release or the behavior of this software, please contact Echoflex Solutions using the information at the bottom of this page.

## Availability

This firmware is currently available in all shipping units and can be upgraded in the field using microSD media. New versions of firmware can be downloaded from ETC Updater software. See [Firmware Installation Instructions on page 3](#) for details.

## Documentation

Current documentation for the Elaho DMX Scene Controller includes the *Elaho DMX Scene Controller Installation Guide*, the *Elaho Inspire Station Programming Guide*, the ElahoAccess App integrated help, and the *ElahoAccess Application Quick Guide*.

Please keep this release note with your installation guide for descriptions of the newest features, changes, and bug fixes. Manuals are in portable document format (pdf) and are available for download at [echoflexsolutions.com](http://echoflexsolutions.com).

# Echoflex Solutions Release Note

## Elaho DMX Scene Controller v3.3.4

---

### Compatibility

For questions regarding compatibility, please contact Echoflex Solutions Technical Services.

### Compatible Elaho Products

This release is interoperable with the following Elaho hardware and software/firmware:

Product	Earliest Device Compatibility	Optimal Feature Compatibility
ElahoAccess App-iOS	v1.0.0	v3.3.1
ElahoAccess App-Android	v1.0.0	v3.3.0
ElahoAccess Interface	v1.0.0	v3.3.4
Elaho Expansion Bridge	v1.0.0	v3.3.4
Elaho BACnet Interface	v3.0.0	v3.3.4
Elaho Integration Interface	v3.3.1	v3.3.4
ElahoTouch	v3.0.0	v3.1.0
Elaho DMX Scene Controller	v1.0.0	v3.3.4
Elaho-Echoflex Interface	v1.0.0	v3.3.4
Elaho Contact Input Interface	v1.0.0	v3.3.4
Elaho Contact Output Interface	v1.0.0	v3.3.4
Elaho Demand Response Interface	v2.0.0	v3.3.4
Elaho Responsive Controls	v1.0.0	v3.3.4
Elaho Dual Tech Occupancy and Vacancy Sensors	v1.0.0	v3.3.4
Elaho Dual Tech Switch-mount Occupancy Sensor	v1.0.0	v3.3.4
Elaho Room Controller - Gen2	v1.0.0	v3.3.4
Elaho Zone Controllers - Gen2	v1.0.0	v3.3.4
Elaho Inspire Stations	v3.0.0	v3.3.4
Elaho Keyswitch Stations	v3.2.0	v3.3.4
Elaho TimeClock	v1.0.0	v3.3.4
Elaho Preset Stations	v3.0.0	v3.3.4
Elaho Relay Panels	v1.0.0	v3.1.2

### Key Enhancements in v3.3.4

- Incorporates improvements from newer Echo Protocol versions

### Key Enhancements in v2.1.0

- Added support for Demand Response features
- Bug fixes

### Key Enhancements in v2.0.0

Using the ElahoAccess App, the following new features are supported:

- Color temperature settings, tint settings, and new fixture profiles
- Power on behavior
- Data loss behavior
- Data active behavior
- Sequence playback
- Supports device renaming in the ElahoAccess App

# Echoflex Solutions Release Note

## Elaho DMX Scene Controller v3.3.4

---

### Firmware Installation Instructions

The Elaho DMX Scene Controller ships with the current version of firmware installed and will not require an update before use. Existing hardware can be field upgraded using a microSD card. New firmware for the Elaho DMX Scene Controller is available through ETC UpdaterAtoR software.

### Update Firmware

1. To update the Elaho DMX Scene Controller firmware, you must first prepare a compatible microSD card with the firmware update file. The firmware update file, labeled `edmx_c_fw.efw`, must reside on the root of the media.



**Note:** *Compatible cards include SDHC microSD media up to 32 GB, formatted to FAT32. SDXC is not compatible.*

---

2. Insert the compatible microSD media into the microSD card slot located on the bottom edge of the Elaho DMX Scene Controller.



**Note:** *The microSD card must be installed into the card slot with notched edge directed right.*

---

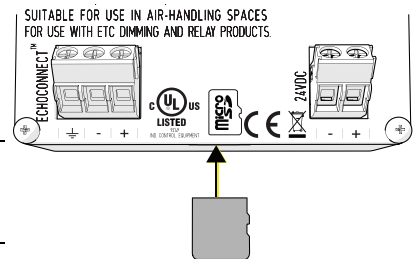

3. Press the **[Reset]** button. LEDs will flash to indicate the update process has begun.



**Note:** *Do not remove the microSD media until the LEDs are no longer flashing.*

---

When the process is complete, the unit will restore to normal operation. View the current version information for the device using the ElahoAccess App. See the ElahoAccess App integrated help system for details.

### Issues Corrected in v3.3.4

None: Incorporates improvements from newer Echo Protocol versions

### Known Issues Remaining in v3.3.4

- EDSC-47044 color zone intensities affected by space scoped h/s changes
- EDSC-47043 DMXSC reports sequence as active when DMXSC sequence is disabled
- EDSC-43119 In certain circumstances, Scene Controller may fail to cache a candidate look to be recalled by power on behavior
- EDSC-43101 EDMXC Save or Copy-To does not save preset data due to the amount of data

### Issues Corrected in Echo Protocol v3.3.4

- EC-47203 Implement Echo Bus communication efficiency reporting

### Issues Corrected in Echo Protocol v3.3.1

- EC-47110 Active status indication can occasionally blink off on busy EchoConnect bus

### Issues Corrected in Echo Protocol v3.3.0

- EC-45338 Bus ID does not re-arbitrate if self powered device loses and later regains bus connectivity while remaining powered

# Echoflex Solutions Release Note

## Elaho DMX Scene Controller v3.3.4

---

### Known Issues Remaining in Echo Protocol v3.3.4

- EC-47116 Space Toggle button on Inspire station not affected by level of ET channel not patched to zone
- EC-47111 Zone/Preset/Sequence status can "flutter" very occasionally due to a receiving host timer rollover
- EC-47077 Multispace off button occasionally flashes on when sequence is still playing
- EC-47074 Off actions using timing from an active preset rather than the 2 second standard
- EC-47070 Mobile app shows sequences active for sequences 2-4, not just 1
- EC-47063 Multispace hosts maintain preset status in previously-patched spaces
- EC-46888 Late joining occupancy sensor controls will assert their configured occupancy action even if associated group was already in occupied state
- EC-45629 Hold event configured with fade time for "set to color" actions fades intensity on hold
- EC-45596 Differing space/zone levels across bridge segments causes station indication to bounce between values
- EC-45462 "Uncombine All" may not uncombine all combined spaces on full Echo bus.
- EC-45202 Editing spaces affected by a Demand Response input momentarily sets spaces to false during true condition
- EC-44495 Products with Power on behavior can show active zone levels and activated Off status at same time
- EC-44432 Manual control from non native space does not trigger occupancy when occupancy action is multi-space
- EC-44154 Occupancy groups, vacancy inhibit, and photo inhibit do not support all spaces of a multi-space action
- EC-43350 Accessing the Config page on multiple simultaneous mobile app connections causes duplicate devices to be listed
- EC-43262 Vacancy action Preset activate can be missed after a grace restore has been triggered due to support for older Occupancy sensors
- EC-43138 On occasion large batches of patch config messages can fail to transmit correctly resulting in skipped addresses
- EC-43020 When two presets are active in the same space, preset indication toggles between both presets
- EC-42572 Unable to toggle sequence off from combined space that does not possess a sequence enabled output product
- EC-42401 Space Combine Toggle won't uncombine spaces without any host output products
- EC-38851 Late joining bridge results in oscillating mismatched Zone values if different segments have different values for same zones
- EC-38839 Late joining bridge results in oscillating mismatched statuses if different segments have different status for same spaces
- EC-38694 Zone status does not zero out after last output product for that zone changes to new space
- EC-35126 Space toggle when Zones are not at full sets Zones to 0 rather than all at full
- EC-34543 Sequence indicator toggles state rapidly when output device with sequence active late joins Echo bus with output device that has inactive sequence
- EC-28417 Station activity during sync period following connection of late joining output product incorrectly does not cause LED chase